

CD-5020A

CD Loader Unit for Audio Products

- Smooth tray loading and eject.
- Low clamp noise.
- PCBA is able to install in the drive bottom.
- Two kinds of emergency eject mechanisms.
- Control I/F : UART
- Digital Audio I/F : I2S and SPDIF
- Adopt shock proof (Buffer memory) *option
- Only 5V is required to supply power.

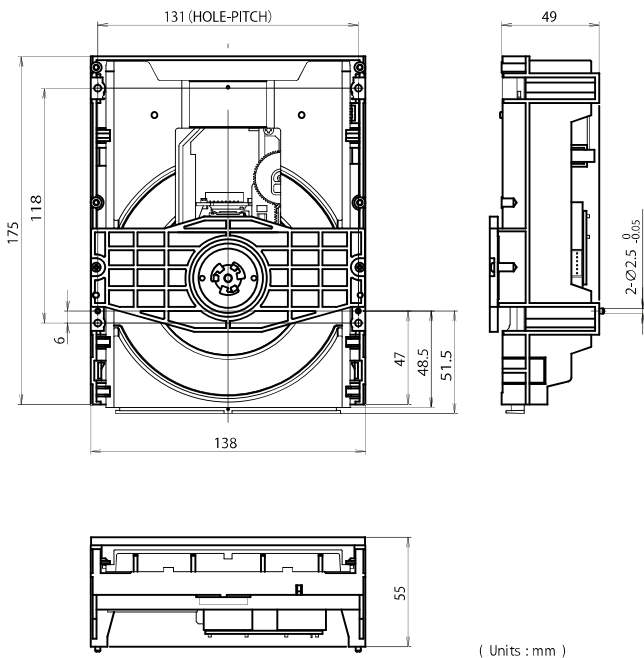

Read Speed	1~2 x
MP3/WMA/AAC Decode	Support
Shock Proof (Buffer RAM)	Option
Control Interface	UART (RTS/CTS)
Audio Interface	I2S / SPDIF
Disc Diameter	12cm , 8cm
Environmental Condition	
Ambient Temperature	Operating 5~45°C
	Non operating -20~60°C
	Transpotation -40~60°C
Relative Humidity	Operating 20~80% (non-condensing)
Power Requirements	DC 5V ± 5%
Loading / Ejecting Life	10,000 times or more
Loading Mechanism	Tray Loading
Dimensions	
Tray Open	138W x 62H x 309D (mm)
Tray Close	138W x 55H x 179.5D (mm)
Mass (Weight)	390g or less
Mounting Orientation	Horizontal
RoHS Directive	Complied



Company names and product names in this document are the trademarks or registered trademarks of their respective owners. Features and specifications are subject to change without notice. Precaution : To ensure safe handling and operation, read the Instruction Manual before use.



株式会社アルメディア オ 営業本部 営業部
 〒186-0002 東京都国立市東1-4-12 KS国立ビル7階 電話 042-511-0480 FAX 042-511-0491
<http://www.almedio.co.jp>

ALMEDIO INC. Sales Headquarters Storage Solution Section
 Kunitachi Office KS kunitachi Building, 7F, 4-12, 1chome, Higashi, Kunitachi-shi, Tokyo, 186-0002, Japan
 Phone +81-42-511-0480 Fax +81-42-511-0491
<http://www.almedio.co.jp>

このカタログの記載内容は2019年9月現在のものです。

The contents presented in this catalog were updated as September 2019.

PRINTED IN JAPAN.